

Wind Turbine Challenge 2.0

Test Stand Assembly

Finished Assembly

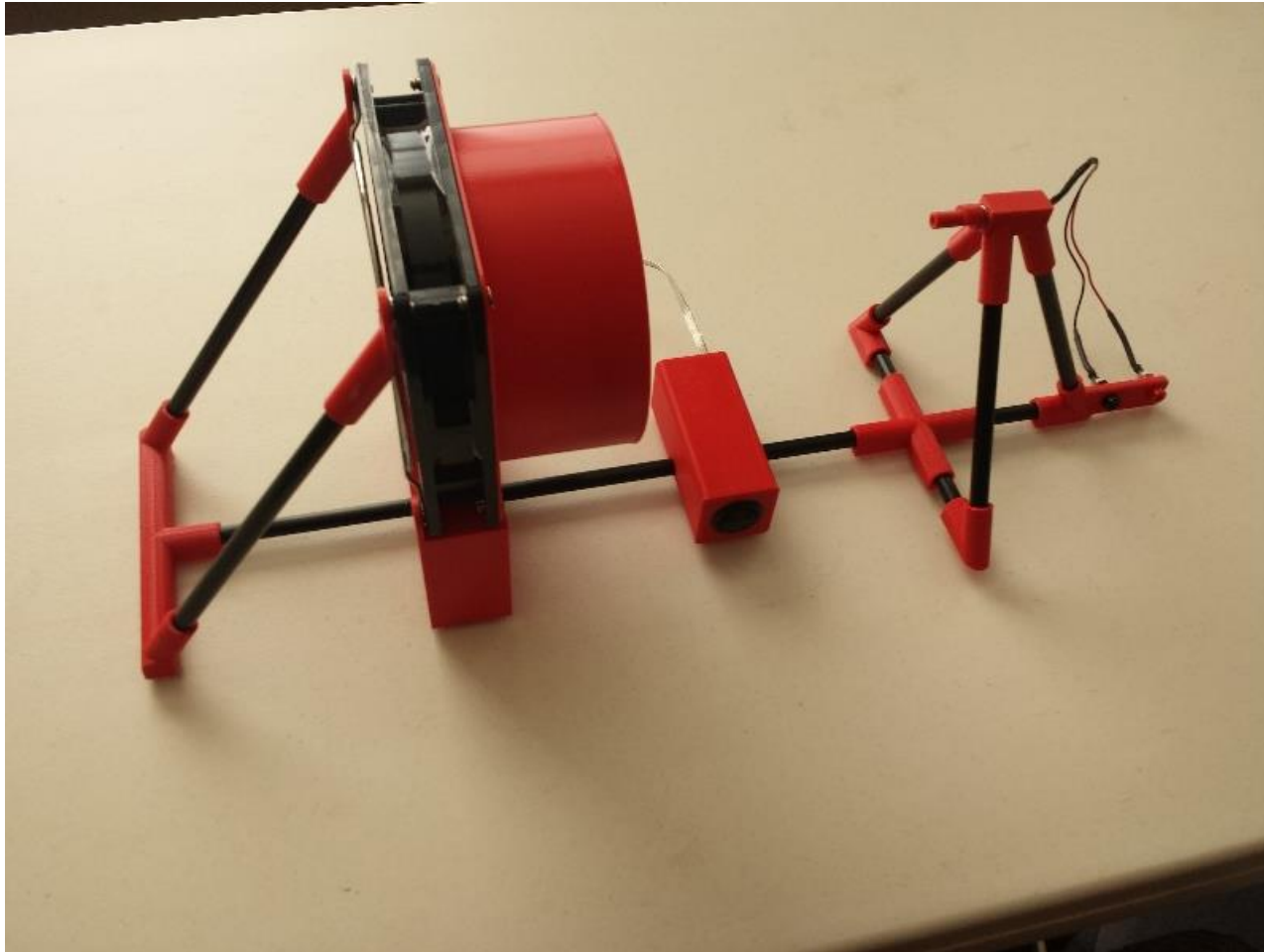

Fan Assembly

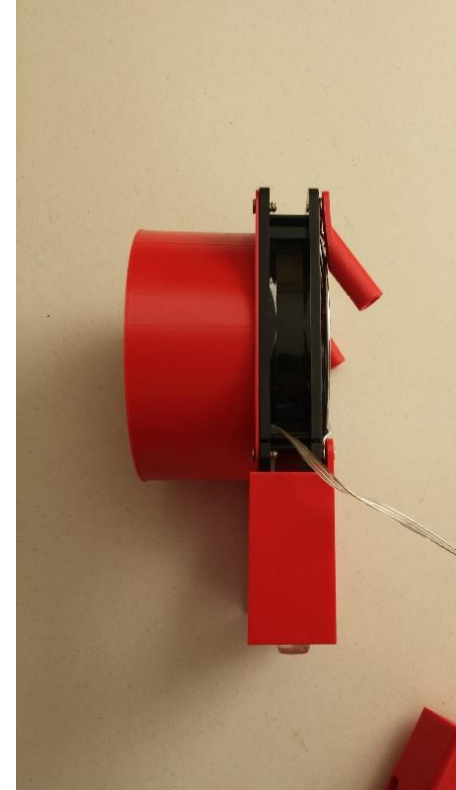

Switch Box Assembly

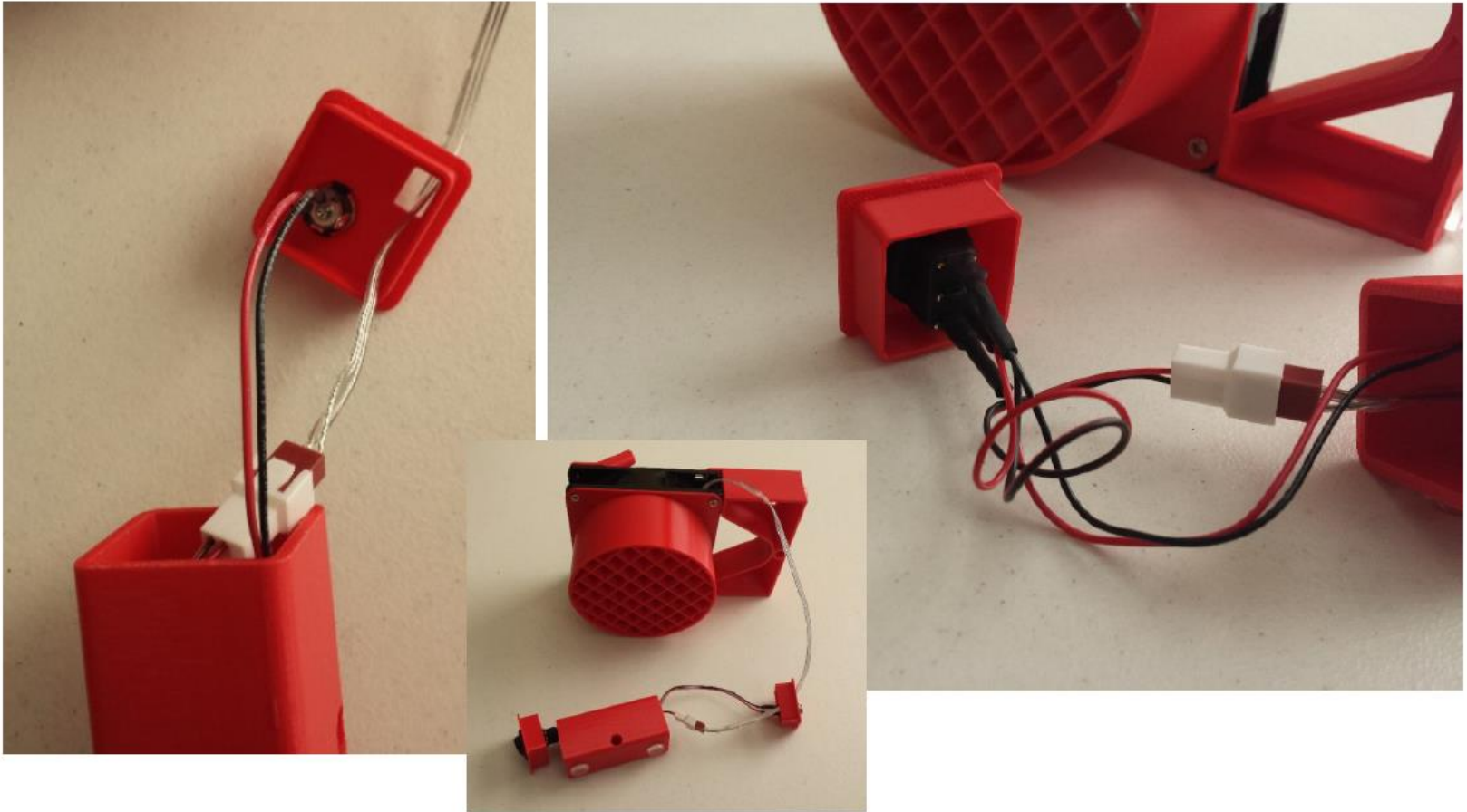

Wiring Diagram

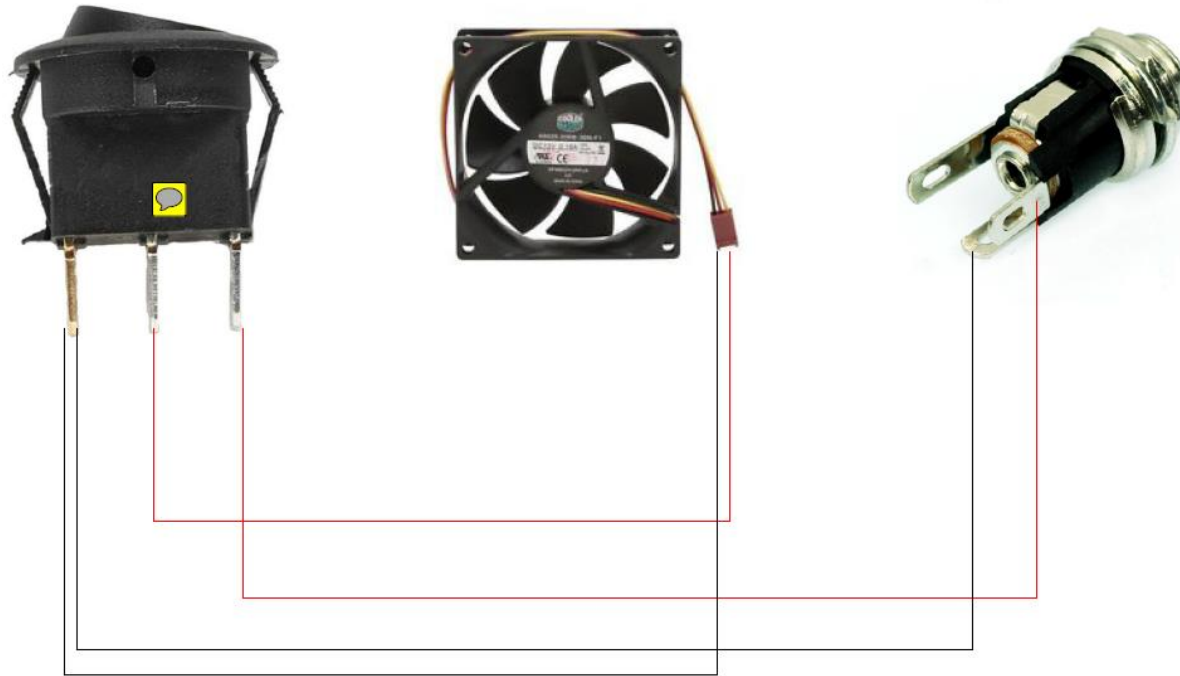

Motor Hub Assembly

Caution: Motor Axis should be horizontal. If not, adjust legs until horizontal position is achieved.

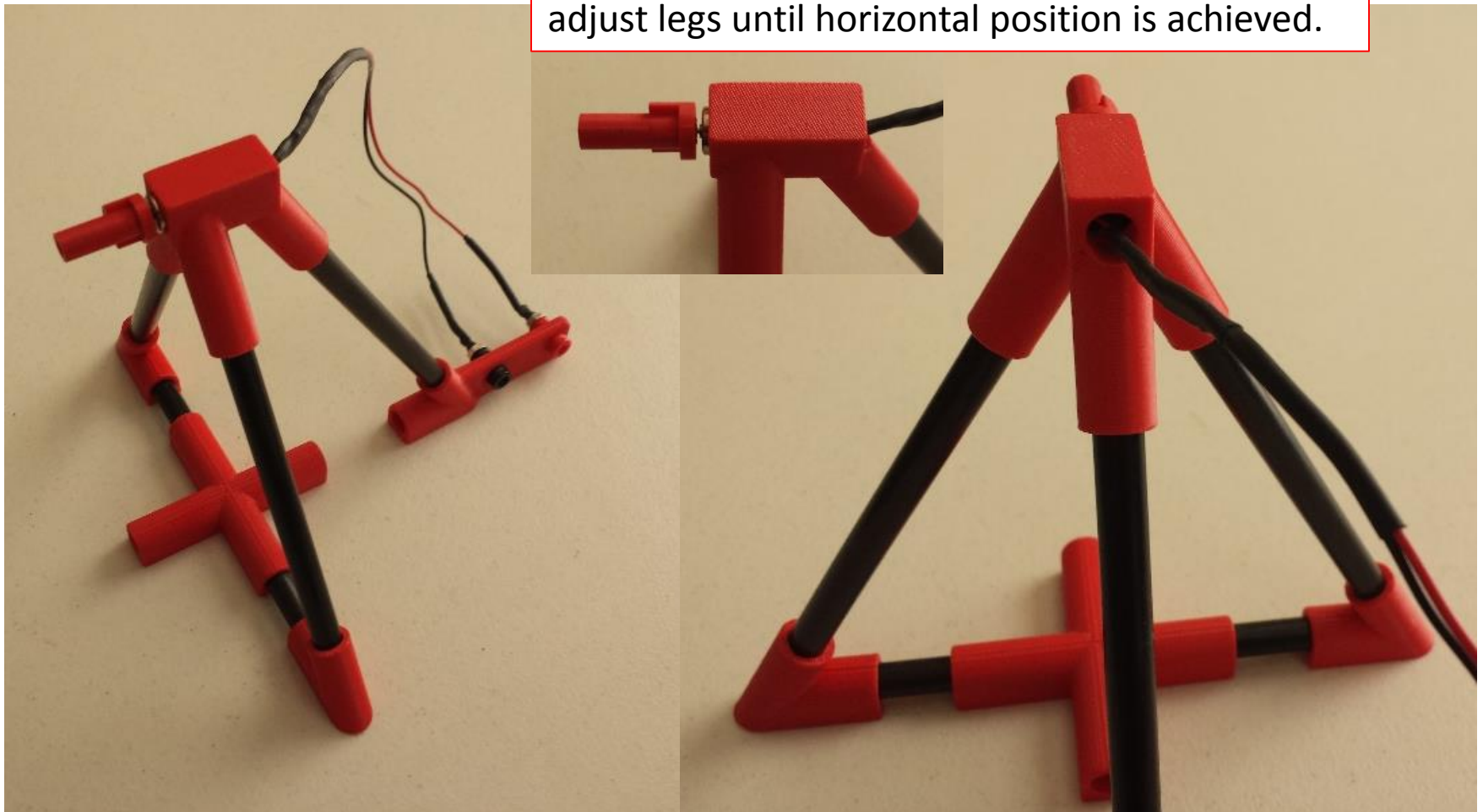

Assembly Sequence 1

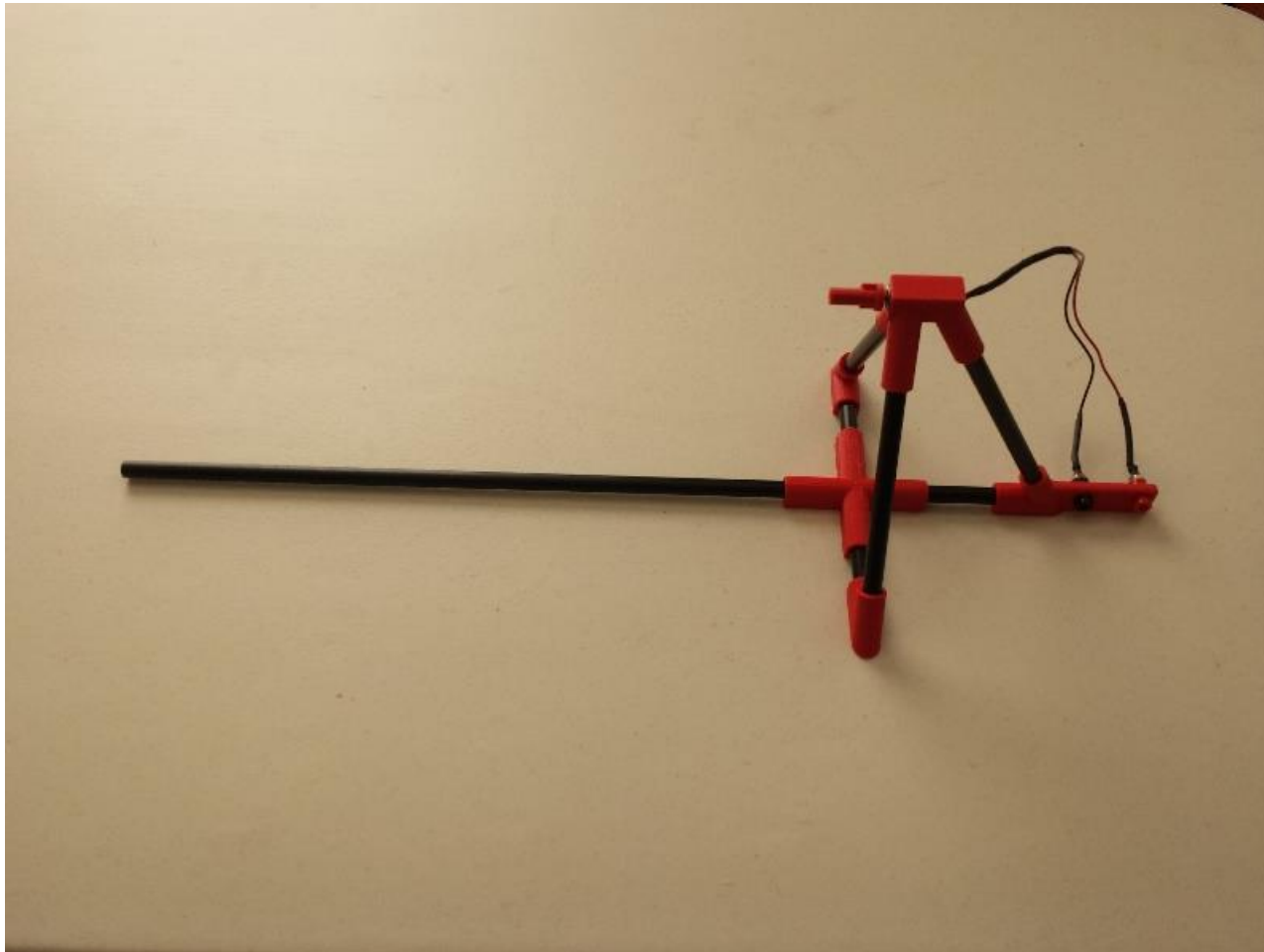

Assembly Sequence 2

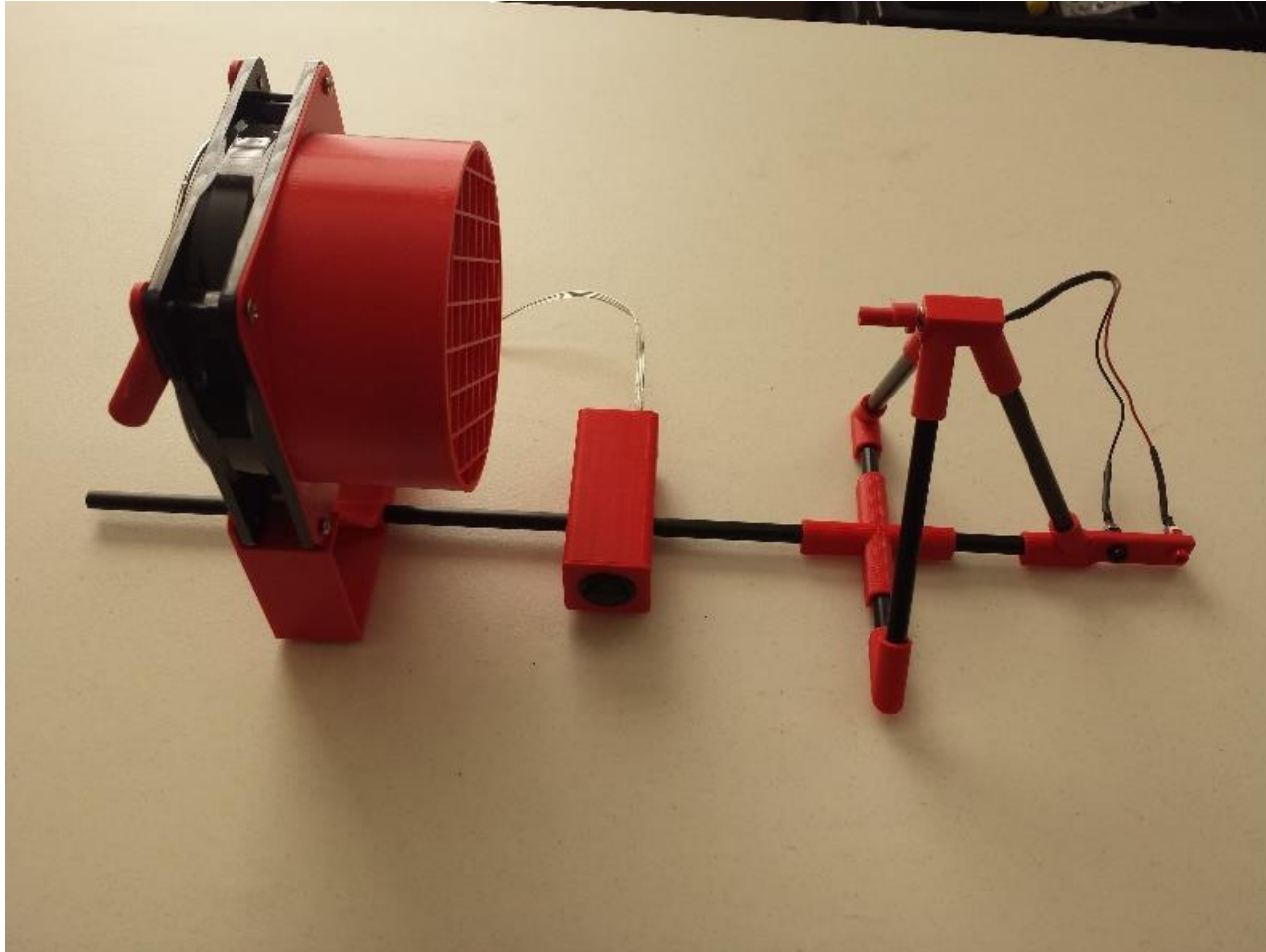

Assembly Sequence 3

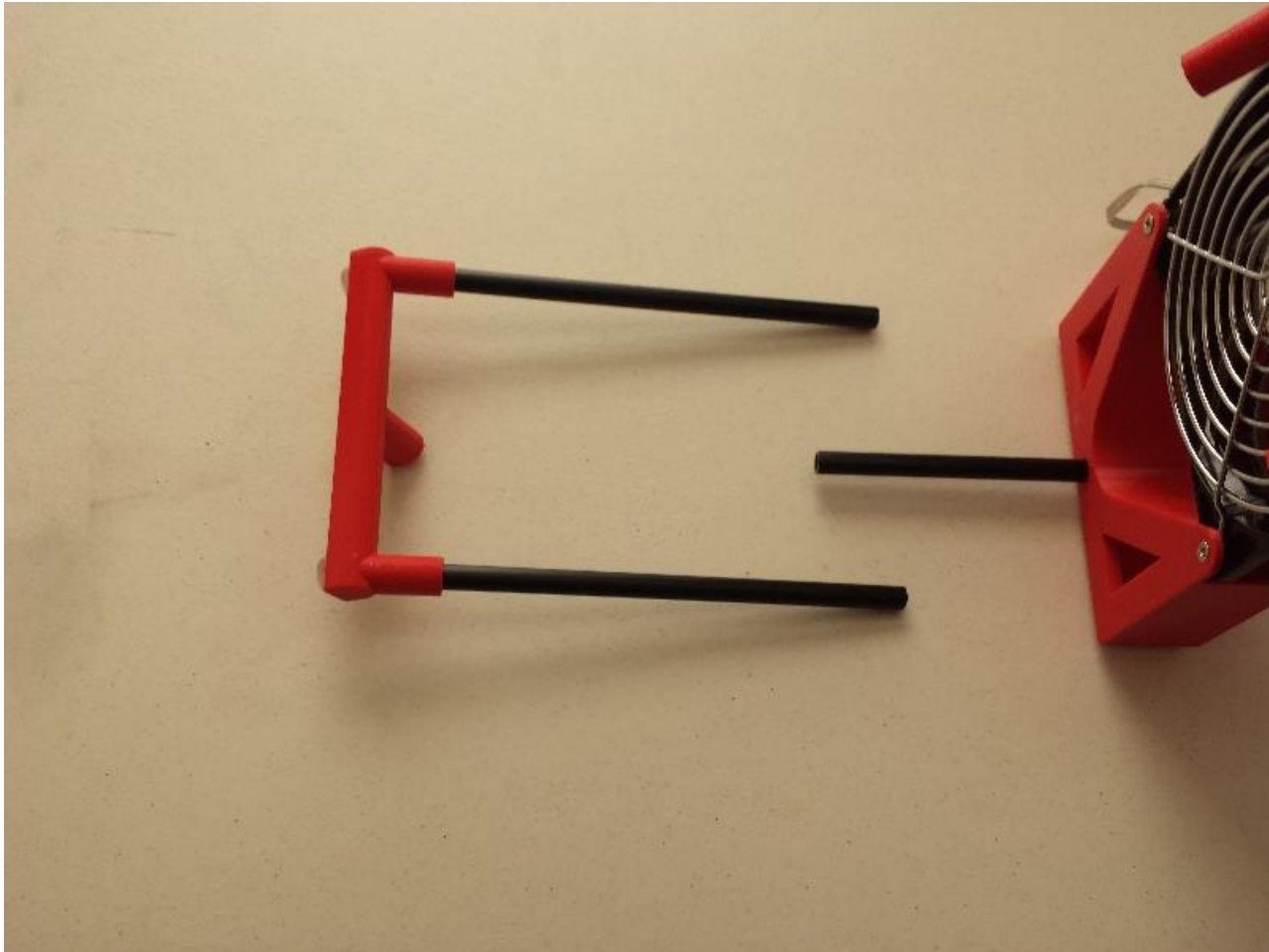

Assembly Sequence 4



Caution: Fan should be vertical. If not, adjust legs until vertical position is achieved.

Assembly Sequence 5

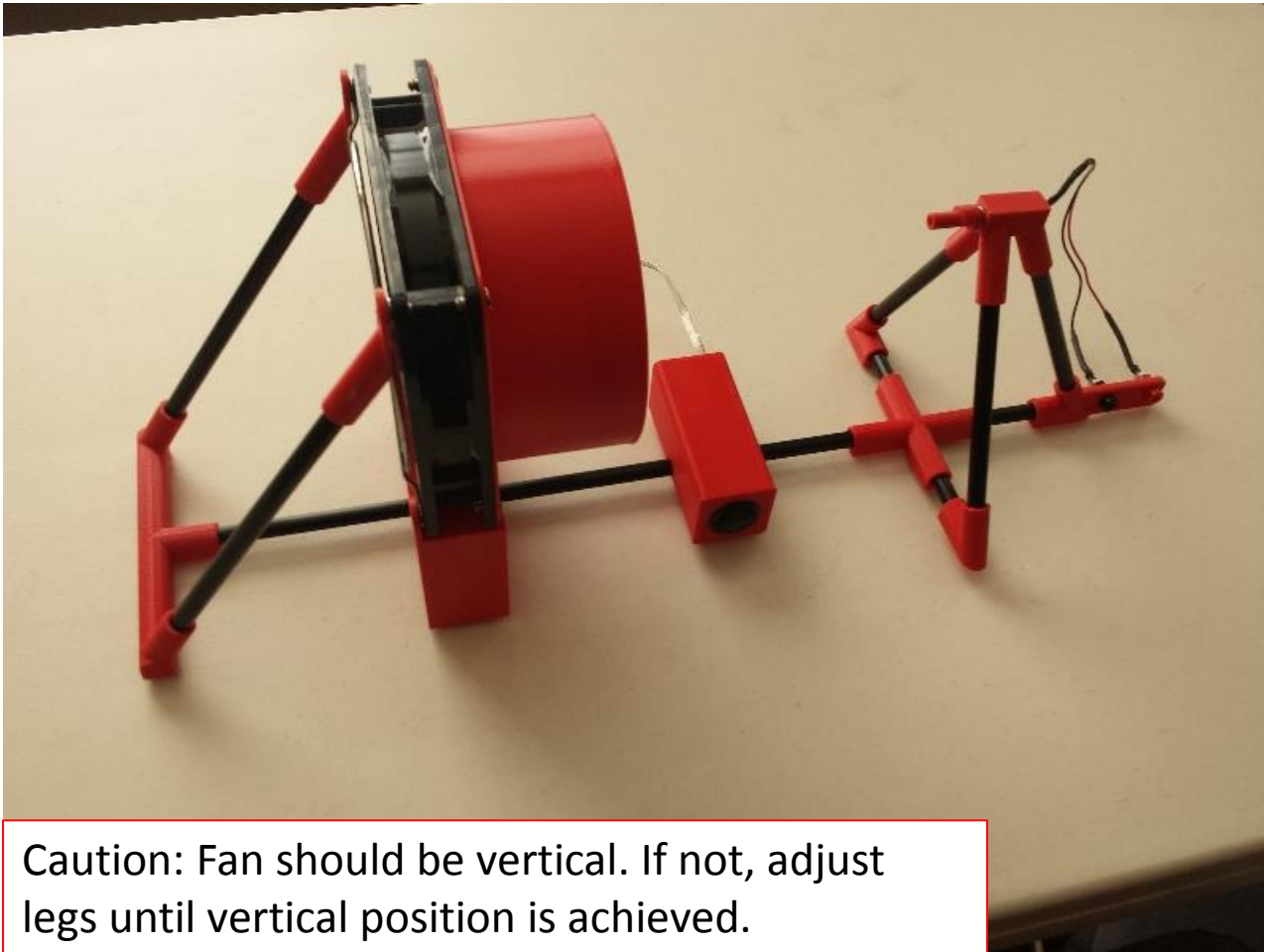

Considerations

- If the test stand does not need to be portable
 - Small dabs of glue at the joints will increase stability
 - We suggest Super glue or Gorilla glue
- Enjoy your test stand!
- Remember
 - Rippl3D Test Stand parts are open sourced on our website!
 - If you break one, you can build your own replacement
 - <http://ripp3d.com/test-stands/>
 - If you find you need some more test stands
 - Consider building your own